

ALTERNATE ACTION RING ILLUMINATED, STAINLESS STEEL CASE & BUTTON



High Profile  
Curved Button

The LP5-V series is an alternate action switch that has been designed to provide attractive, lighted position indication for applications in harsh environments, where security and reliability are paramount. The series features both aluminum and stainless steel cases watertight to IP68S. Momentary action is available in the LP3-V series.

This high reliability switch offers the durability and ruggedness our customers have come to expect with the added benefit of illumination. Ideal for marine, off-highway and industrial control applications that require an illuminated switch.

This switch offers positive tactile feedback, less than 25mΩ contact resistance, and a variety of LED colors available in both flat and domed actuator bezel shapes.

## Features:

- Security (aluminum) or vandal resistant (stainless steel) case & button
- Ring illuminated
- Watertight to IP68S
- RoHS & WEEE compliant
- Less than 25mΩ contact resistance
- Variety of button options
- Variety of LED colors
- Drop in replacement to the P5-V series
- UL component recognized
- UL1500 ignition protected

### Standard Characteristics/Ratings:

#### ELECTRICAL RATINGS:

Load	Sea Level @ 28VDC or 115VAC, 60/400Hz
Resistive	5A
Inductive	3A
Lamp	1A
Motor	3A
DWV	1050Vrms
Low Level	10mA @ 30mV

Electrical Life: 25,000 cycles

#### LIGHTING:

Light Source Voltage (DC)	Actual Voltage Nominal (DC)	Voltage Max (DC)
2	2	2.6
6	7	8
12	13.5	14.5
24	28	28.6

Mechanical Life: 200,000 cycles

Seal: IP64 or IP68S

Operating Temp Range: -55°C to +85°C

Operating Force: 3.0 lbs. +1.0/-0.5 lb.

Total Travel: 0.180 inches max

Overtravel: 0.012 inches min

#### MATERIALS:

Case: Stainless steel

Button: Thermoplastic

Center Cap: Stainless steel or aluminum

Terminals: Standard silver plate with optional gold plating for low level applications

Mounting Hardware: Hex nut, lockwasher and panel seal gasket

## LP5-V PART NUMBER CODE

Type	Case Style	Circuit Rating	Light Source Type* w/ Rev. Pol Protection	Seal Level	Case/Center Cap Color	Button Profile
A. Aluminum	1. 5/8-24 & Hex Nut	0. Indicator Light	A. 2V Red LED	2. Dusttight	1. Silver	1. High Profile Flat Button
V. Stainless	2. 5/8-24 & Knurl Nut	1. SPST/Std.	B. 2V Green LED	3. Watertight	2. Black**	2. High Profile Curved Button
	3. 5/8-24 W/D-Flat & Hex Nut	2. SPDT/Std.	C. 2V Amber LED			3. Low Profile Flat Button
	4. 5/8-24 W/D-Flat & Knurl Nut	3. SPST/Low Level	D. 6V Red LED			4. Low Profile Curved Button
	5. 3/4-20 & Hex Nut	4. SPDT/Low Level	E. 6V Green LED			5. Flush Profile Flat Button
	6. 3/4-20 & Knurl Nut		F. 6V Amber LED			
	7. 3/4-20 W/D-Flat & Hex Nut		G. 12V Red LED			
	8. 3/4-20 W/D-Flat & Knurl Nut		H. 12V Green LED			
			J. 12V Amber LED			
			K. 24V Red LED			
			L. 24V Green LED			
			M. 24V Amber LED			
			N. 2V Blue LED			
			P. 6V Blue LED			
			Q. 12V Blue LED			
			R. 24V Blue LED			

\* For additional LED lighting options, contact factory.  
\*\* Only available on LP5-A styles.

# ILLUMINATED VANDAL RESISTANT PUSHBUTTONS

**LP5-V**  
ILLUMINATED  
VANDAL RESISTANT  
PUSHBUTTONS

## ALTERNATE ACTION RING ILLUMINATED, STAINLESS STEEL CASE & BUTTON

High Profile Flat Button  
Style 1

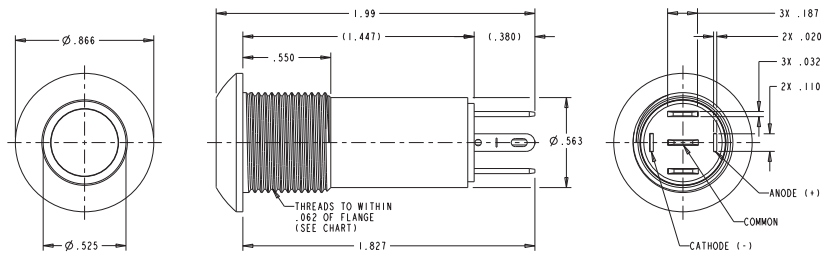

High Profile Curved Button  
Style 2

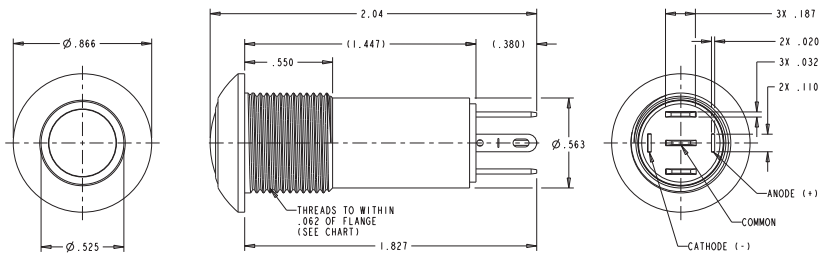

Low Profile Flat Button  
Style 3

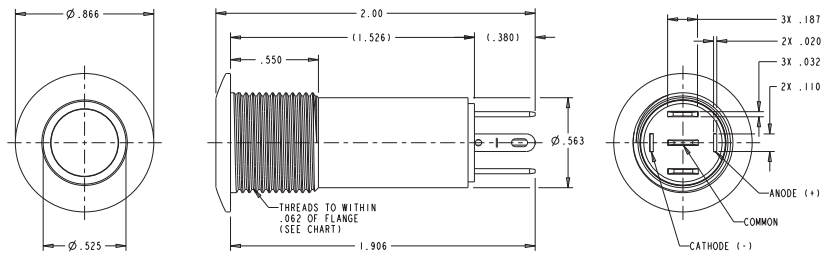

Low Profile Curved Button  
Style 4

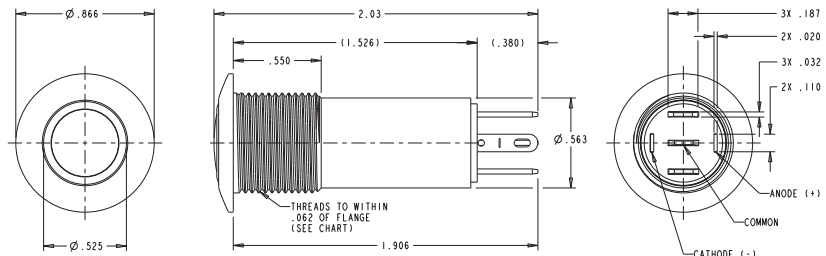

Flush Profile Flat Button  
Style 5

